

ROTARY CYLINDER

RTU-25, 40, 50



SRJ
SDRJ
RJC
RTU
SSU
MSRJ

특징 (Character)

- 2개의 핑거를 90도로 취부회전시키는 직교 회전 유니트
Rectangular rotary unit which mounting and rotating two fingers 90 degrees
- AF30, AF46 type FINGER 선정시 Compact 한 모듈 구성이 용이
Ease to organize compact module in case of selecting AF30, AF46 type finger
- 속압쇼바 내장으로 충격력 흡수의 최대화 가능
Possible to maximize shock absorption through built shock absorber
- AF28D 와 같은 경량화 핑거 사용을 권장
Recommendation to use light weight finger like AF28D

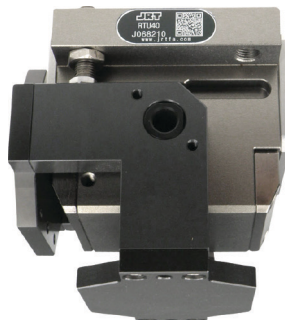

그리퍼 부착이 용이한 90도 회전 유니트 (Gripper attachable 90° swivel unit)

그리퍼 플레이트 (Gripper plate)

그리퍼 부착용 플레이트
for connection to application
specific adapter plate

속압쇼바 (Shock absorber)

내장 속압쇼바
built-in shock absorber

구동부 (Drive)

복동식
double acting
pneumatic cylinder

바디 (Body)

경질 처리된 경량의
알루미늄 합금
High-tensile aluminum body with
lightest possible because of
hard anodizing

작동방식 (Kinetics)

랙 / 피니언 방식
pinion/toothed rack system for low
tolerance transmission of drive power
in one rotation movement

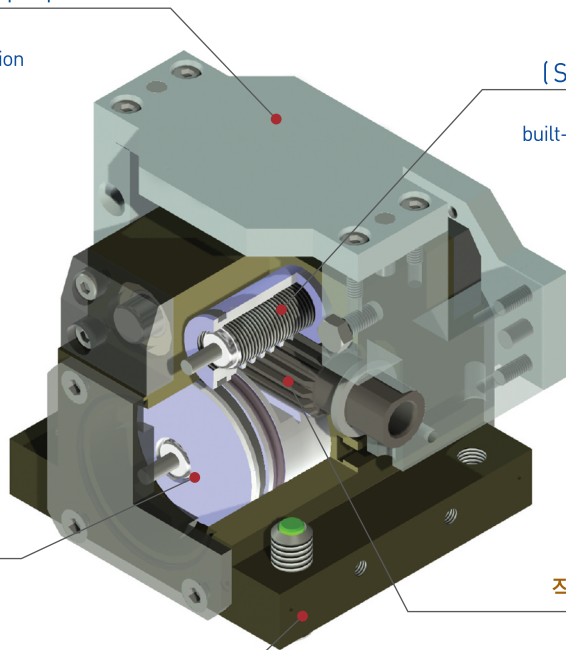

부품분해도 (Exploded view)

※ 본 분해도는 한 제품을 예시하였으므로 기종별로 차이가 있을 수 있습니다.
 ※ This exploded view illustrates a certain product only. The contents may vary by product models.

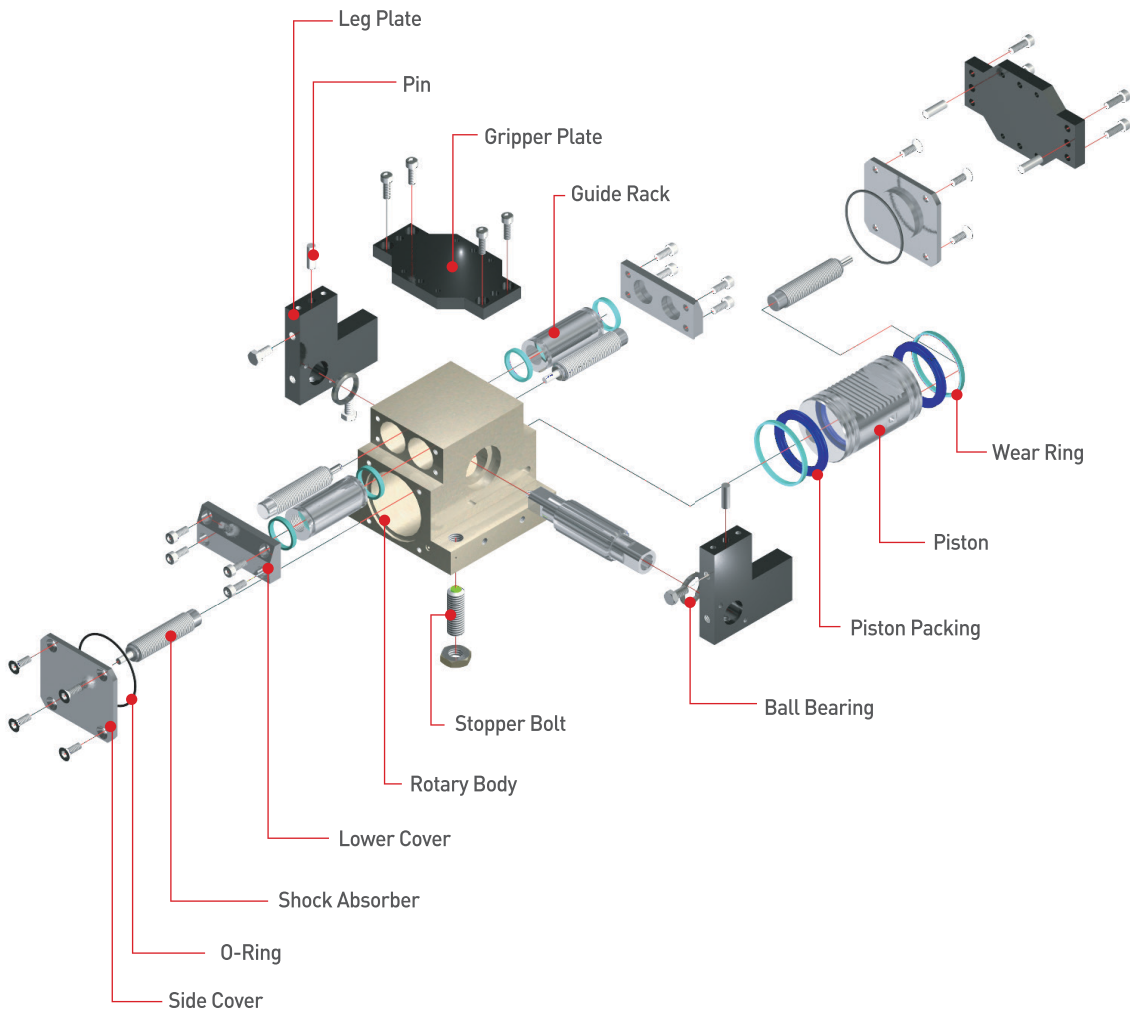

주문기호 (Ordering Code)

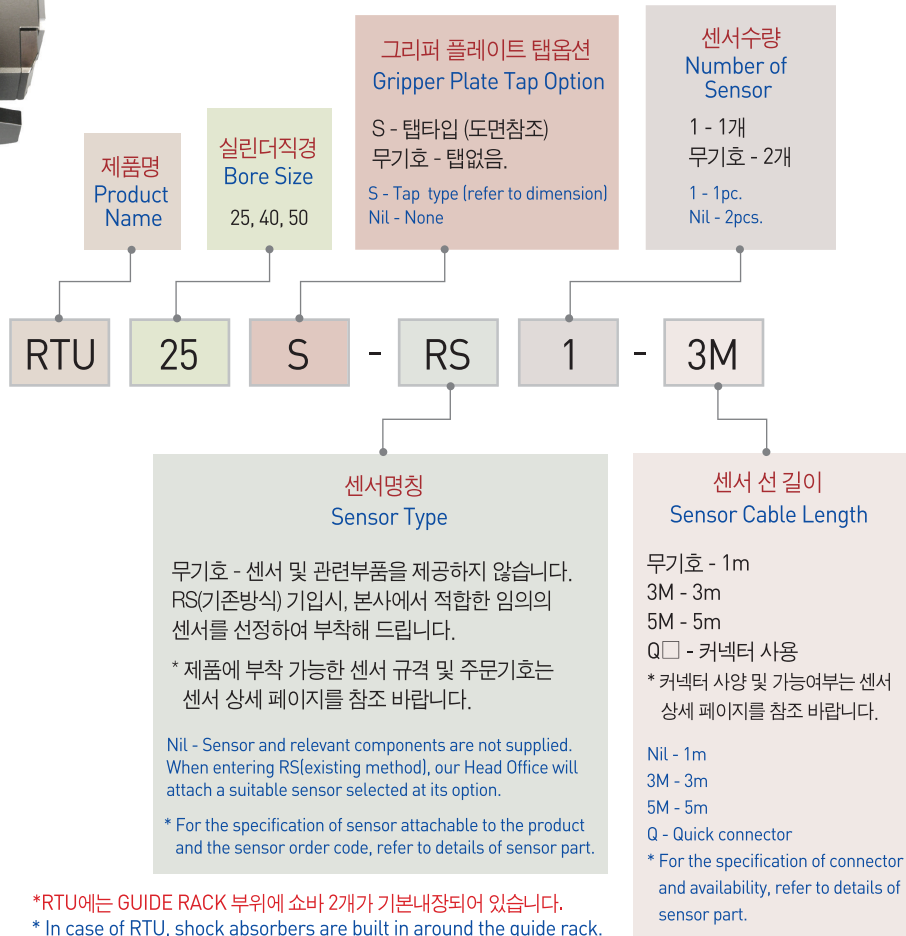

RTU & Gripper Standard Assembly

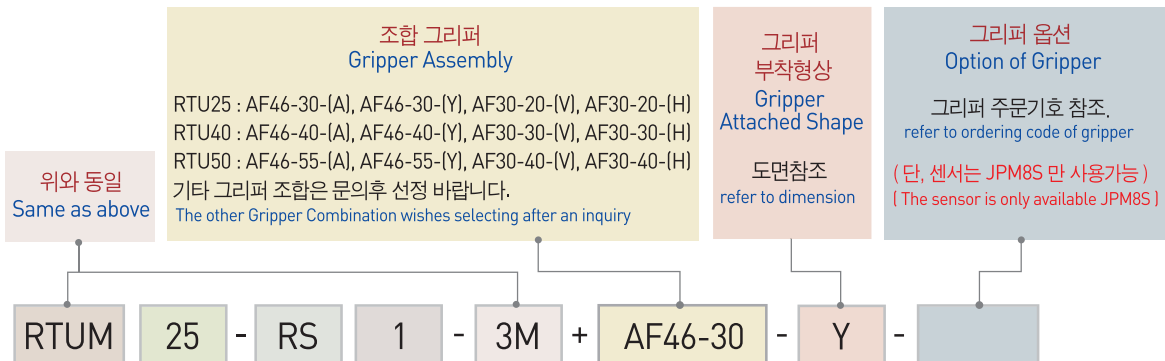

▣ 제품사양 (Specification)

P=공기압력(bar)
P=Air Pressure(bar)

제품명칭 Products Name	RTU25	RTU40	RTU50	단위 Unit
실효토크 Actual Torque	0.169P	0.774P	1.411P	N.m
축직각하중 Radial payload	1.2	1.9	2.8	kg
축방향 압축하중 Compress load(thrust)	0.6	1.2	1.6	kg
제품중량 Weight	0.68	1.97	3.24	kg
회전시간 Turning Time	0.5	0.8	1.0	sec
배관접속구 Fitting size	M5	M5	PF(G) 1/8	
공기소모량 Air consumption quantity	7.7	35.5	64.8	cm ³
원충장치 Cushion	압쇼바 Absorber			
반복위치정밀도 Repetition Accuracy	±0.1			degree
사용압력 Operating pressure	3 to 7			bar
주위온도 Ambient temperature	-5 to 60			℃
윤활 Lubrication	불필요 Needless			

반복정밀도 : 연속100회 작동 후 측정치
After 100 consecutive strokes to end positions

RTU-25-S(V,H)

- SRJ
- SDRJ
- RJC
- RTU
- SSU
- MSRJ

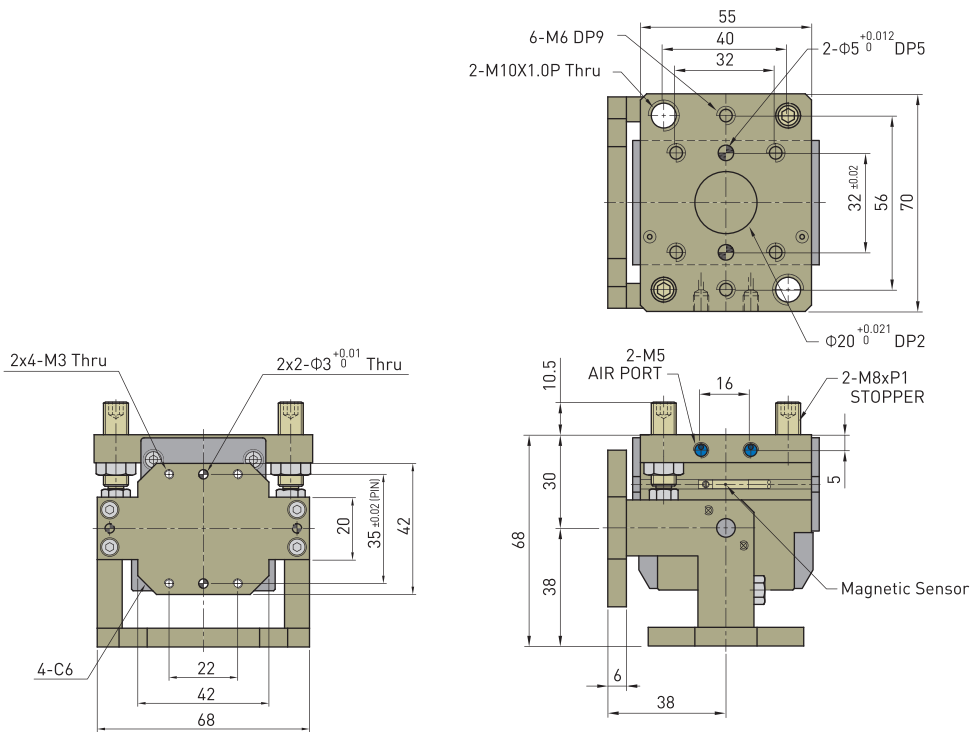

RTU25 Standard Assembly

RTU25 + AF46-30A

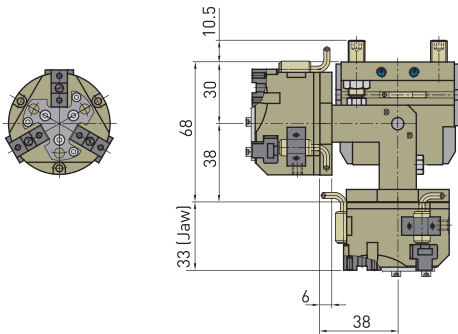

RTU25 + AF46-30Y

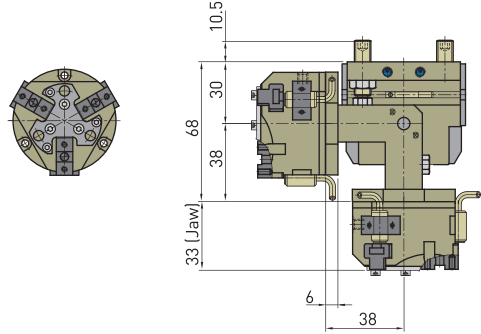

RTU25 + AF30-20V

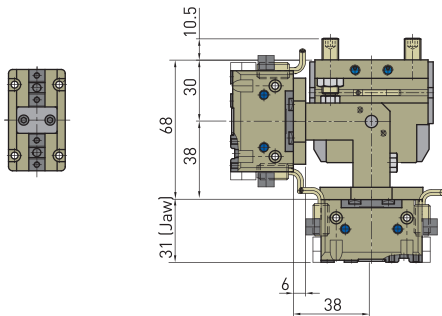

RTU25 + AF30-20H

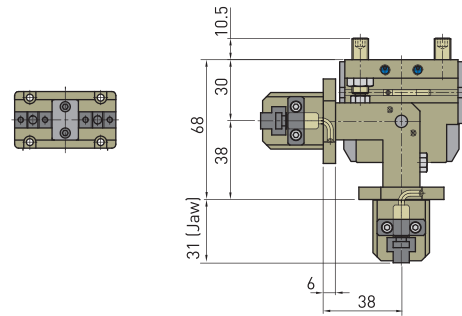

* PS센서사용불가
* PS Sensor is not available to attach.

RTU-40-S(V,H)

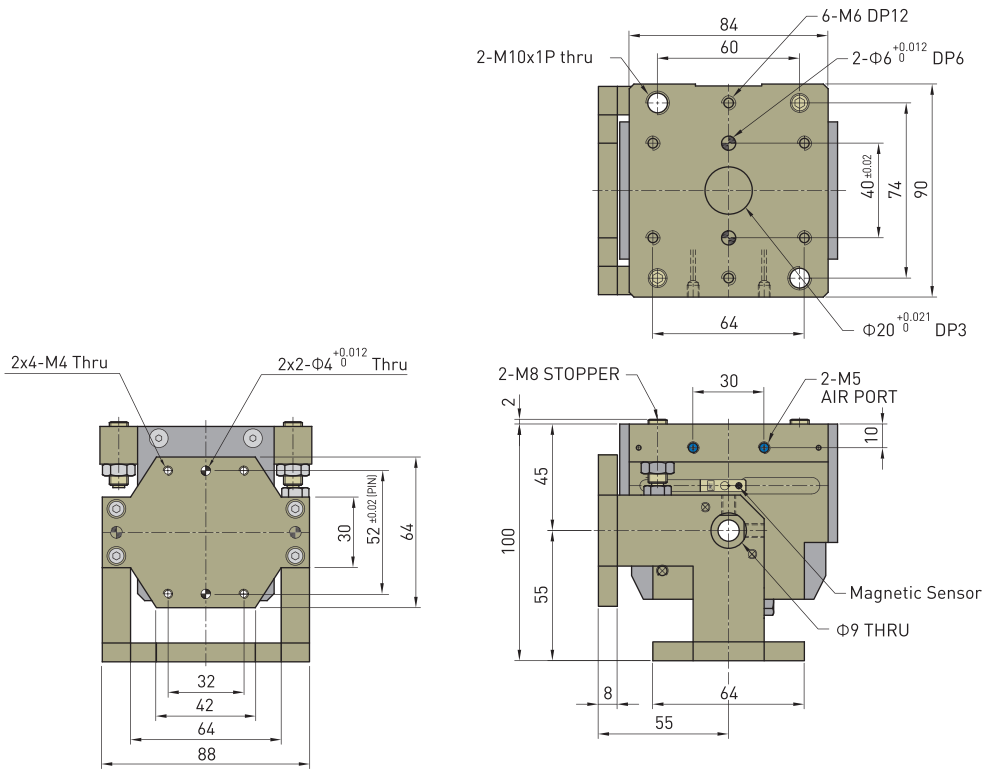

RTU40 Standard Assembly

RTU40 + AF46-40A

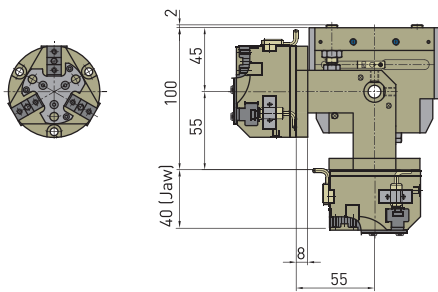

RTU40 + AF46-40Y

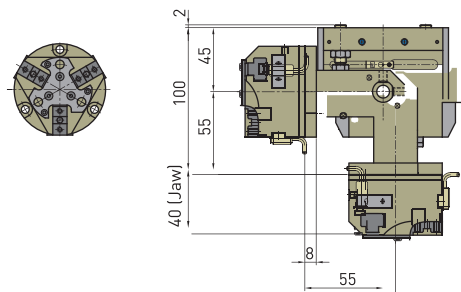

RTU40 + AF30-30V

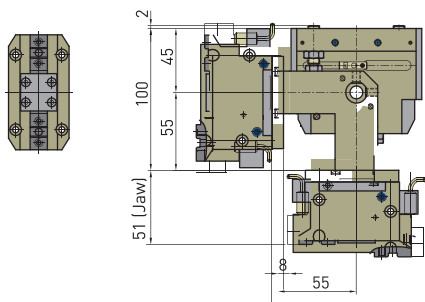

RTU40 + AF30-30H

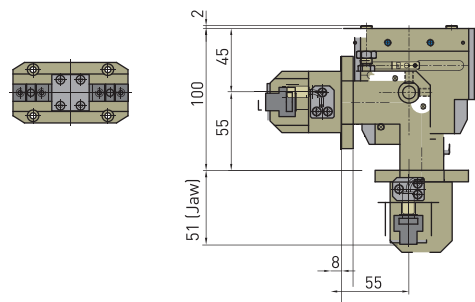

- SRJ
- SDRJ
- RJC
- RTU
- SSU
- MSRJ

RTU-50-S(V,H)

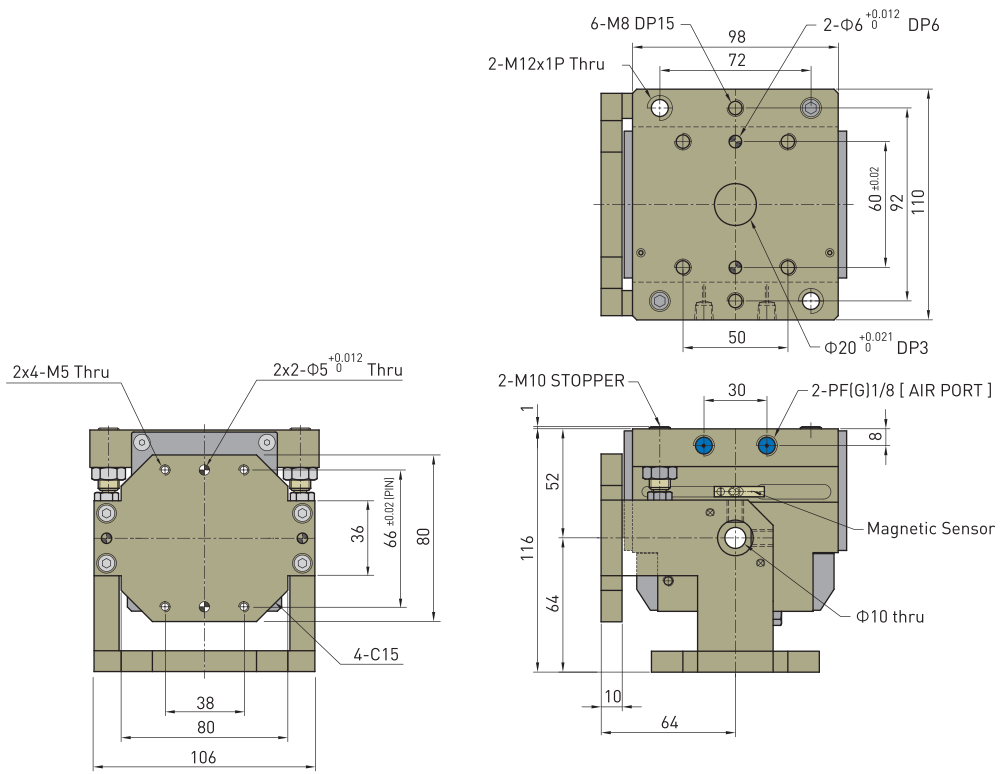

RTU50 Standard Assembly

RTU50 + AF46-55A

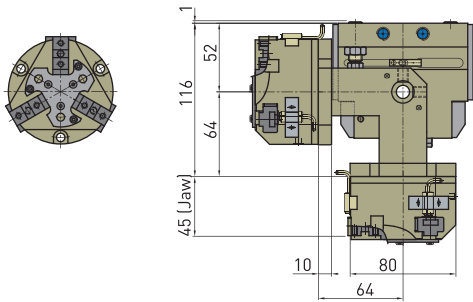

RTU50 + AF46-55Y

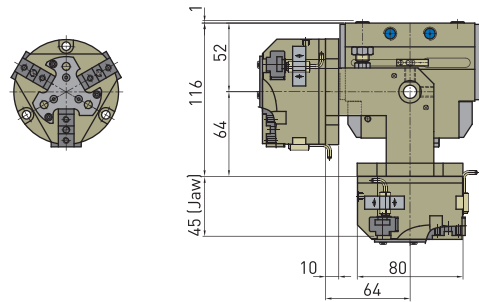

RTU50 + AF30-40V



RTU50 + AF30-40H

